

Mxx

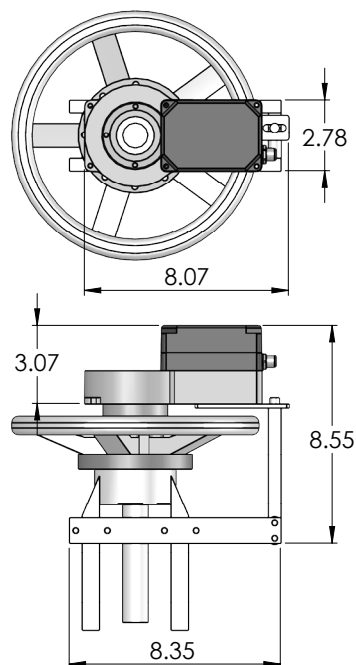

Rxx

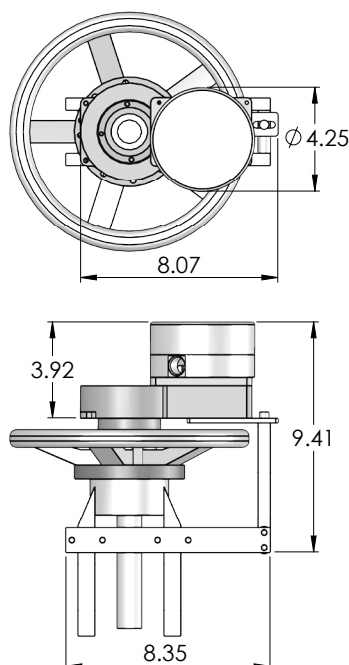

Hanbay's G-Stage mounting kit adapts to any gate valve up to 6" in size. Reduce open and close time with this 12-24VDC compact actuator. It also works on rising/non-rising gate valve stems.

Torque: Up to 532 in-lbs

Applications:

Industrial & Commercial	Potable water filtration, cooling tower water control, building systems, fire suppression, & irrigation control.
Municipal Water Treatment	Drinking water, residential water treatment, & wastewater treatment
High & Low Viscuous Fluids	Oil, gas, air, hydrocarbon, lubrication, petroleum, slurry, powder product and more..

Description and Specifications:

Enclosure: Aluminum die cast anodized, stainless
 (Rxx)
 Class I, Div 1 Groups B, C, D/ T6
 Class II Groups E, F, G/ T6(85 deg. cel)

Temperature range: 0 .. 65 deg C° internal
 (derate duty cycle at high temp.)

Ext. temp. range: -40 .. 60 deg C° (option Heater)

Stall protection: Electronic position and motion detection

Feedback: TTL, 4 - 20mA

Gears & Bearings: Metal and bronze, oiled/greased for life

Life Expectance: 250,000 cycles in specified conditions

Motor: Brushless DC motor, computer control

Voltages/Current: 12-24 VDC/Max3A @ 24VDC
 110/220 VAC/Max1.5A @ 110/220VAC

Control options: Analog (4 - 20 mA, 1 - 5 V, 1 - 10 V),
 Modbus, TTL (on/off)

Certifications:

ICES-001 ISSUE 4 JUNE 2006

FCC 47 CFR PART 15 SUBPART B

EN 61362-1:2013
 (GROUP 1, CLASS A; Industrial electromagnetic environment)

IP 66/67/68 (60529:2013) (Rxx Series only)

CSA & IECEx Certified Enclosure (Rxx Series only)